

## Series: 020 SCP

**Single Phase SSR (240~440VAC)  
25~90Amps**

INPUT : DC Control  
OUTPUT : SCR



Schematic

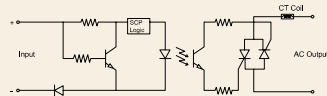

Mechanical Drawing

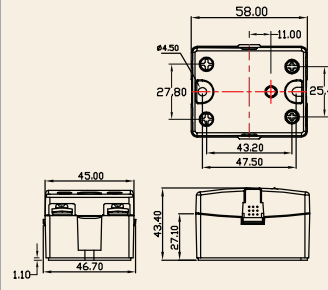

Derating Curve

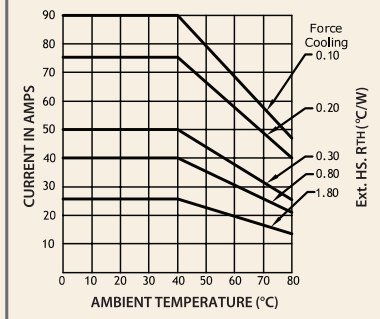

### Salient Features

- Opto Isolation 2500 VAC • Gets Protected Against Load Short Circuits • Zero Voltage Turn On • Reverse Voltage Protection • TTL Compatible (Sink Mode) • Output NO Configuration • Built - In Snubber • Panel Mountable • Higher Load Cycle resistance • High Thermal Cycling Capacity • High Fusing Current • Normal / Fault Indication

ELECTRICAL SPECIFICATION @ TA = 25°C			NOTE: FOR RANDOM T-ON SSR, ADD LETTER 'K' IN PLACE OF 'J'				
PARAMETER	SYMBOL	UNIT	PRODUCT PART NUMBERS				
			<b>020 SCP 482500</b>	<b>020 SCP 484000</b>	<b>020 SCP 485000</b>	<b>020 SCP 487500</b>	<b>020 SCP 489000</b>

### INPUT

PARAMETER	SYMBOL	UNIT	020 SCP 482500	020 SCP 484000	020 SCP 485000	020 SCP 487500	020 SCP 489000
Control Voltage Range		Vdc	6-30	6-30	6-30	6-30	6-30
Control Current Range		mA	50	50	50	50	50
Pick-up Voltage		Vdc	6.0	6.0	6.0	6.0	6.0
Drop-out Voltage		Vdc	1.0	1.0	1.0	1.0	1.0
Input Resistance		KOhms	0.6	0.6	0.6	0.6	0.6

### OUTPUT

PARAMETER	SYMBOL	UNIT	020 SCP 482500	020 SCP 484000	020 SCP 485000	020 SCP 487500	020 SCP 489000
RMS on state Current	IT	A	25	40	50	75	90
Mains Control Voltage	Vrms	Vac	48-480	48-480	48-480	48-480	48-480
Rep Peak Off state Voltage	Vdrm	Vpk	800	800	800	800	800
Peak one cycle surge Current (Non-Rep)	ITSM	A	800	800	520	750	870
On state Voltage Drop	V <sub>TM</sub>	Vac	1.6	1.6	1.6	1.6	1.6
Off state Leakage current	I <sub>drm</sub>	mA	5	5	5	5	5
Zero T-On Voltage		Vpk	25	25	25	25	25
Critical Rate of Rise Off state Voltage	dv/dt	V/μs	475	475	1000	1000	1000
Holding Current	I <sub>H</sub>	mA	80	80	150	200	100
Fusing Current	I <sup>2</sup> T	A <sup>2</sup> s	3745	3745	1350	2812	3780
Thermal Resistance	R <sub>TH</sub>	°C/W	0.86	0.86	1.0	0.6	0.8
Turn-On [Zero/Random]	T-On	ms	10/0.1	10/0.1	10/0.1	10/0.1	10/0.1
Turn-Off [Zero/Random]	T-Off	ms	10	10	10	10	10
Frequency Range	f	Hz	47~63	47~63	47~63	47~63	47~63
Operating Temp	T Oper	°C	-30 to +80	-30 to +80	-30 to +80	-30 to +80	-30 to +80

